

Novis VitaJuicer Operating Instructions

Contents

Page

Safety instructions	1
Important safety procedures	2
Purchased parts package	3
Before start of operation	4
Shortening the cable	4
Operation	5
Tips	8
Product care and cleaning	9
Troubleshooting	10
Disposal	10
Technical data	11
Warranty	11
After-sales service	11

Scope of application

These operating instructions apply to the following models:

Model	Type
Novis VitaJuicer	6500

Safety instructions

Your safety and the safety of others are of great importance.

These operating instructions include several pieces of advice on safety. Please read and always follow all these safety instructions.



This symbol is used to flag up risks and hazards which could potentially lead to death or injury. All the safety instructions indicate the type of danger and give advice as to how you can avoid risk of injury and explain the consequences of failing to heed this advice.



This symbol flags up useful hints.

Important safety procedures



The basic safety procedures set out below must always be followed when using electrical appliances.

1. Please read these operating instructions carefully.
2. About how to clean the surfaces in contact with food please see "Care and Cleaning".
3. Never immerse the Novis VitaJuicer in water or other liquids in order to avoid the risk of electric shock.
4. This Novis VitaJuicer is not designed to be used by children. Persons with physical or mental disabilities or limited sensory perception and also persons who are inexperienced or uninformed should only operate the Novis VitaJuicer under the supervision or guidance of another person who is responsible for their safety.
5. Unplug the Novis VitaJuicer when it is not in use, before fitting or removing attachments, and before cleaning the Novis VitaJuicer.
6. Do not touch moving parts.
7. Do not operate the Novis VitaJuicer with a damaged cable or plug or after it has malfunctioned or been dropped or damaged in some other way. Have the Novis VitaJuicer inspected by your nearest Novis after-sales service point.
8. If the plug does not fit in the socket, please consult a qualified electrician. The plug may only be exchanged by a duly qualified professional.
9. The use of accessories which do not bear the Novis name may cause fire, electric shock or injuries.
10. Do not use the appliance outdoors.
11. Do not allow the mains lead to dangle over the edge of the table or work surface.
12. When processing ingredients, do not reach into the feed chute with your hands or with utensils as this could cause serious injuries or damage to the appliance. Only use the pusher provided.
13. The shredder disc is sharp. Handle it with care.
14. Make sure that the lid or pulp collector is firmly locked in position before switching on the Novis VitaJuicer.
15. Always use the pusher to push the ingredients down.
16. Do not attempt to avoid the catch on the lid or on the pulp collector and the inner container.
17. Never use defective parts. Contact your stockist or the addresses given in the section on after-sales service.
18. If the power cord is damaged, it must be replaced by the manufacturer or a suitably qualified professional in order to prevent any further danger/damage.
19. Do not use the Novis Vita Juicer if the rotary shredder disk is operating or the protective cover is damaged or has visible cracks/damage.
20. Most juices require processing times of 2 to 5 minutes. The Novis VitaJuicer can be operated continuously for up to 20

minutes.

21. **Keep the appliance and its cord out of reach of children. Children shall not play with the appliance.**
22. **Appliance misuse can cause possible injuries.**
23. **Care shall be taken when handling the sharp cutting blades, emptying the bowl and during cleaning.**
24. **Do not use the appliance if the rotating sieve is damaged or has visible cracks.**













This product is designed for household use only.

Keep these operating instructions for future reference.

Purchased parts package

Check that all the parts have been supplied with the product. Please contact your stockist without delay if any parts are missing. The operating instructions include a description of how to safely use the accessories supplied with the juicer.

Novis VitaJuicer	
Citrus Reamer/CitroMax	
Pulp collector	
Citrus cover	
Smoothie/puree unit	
Pusher	

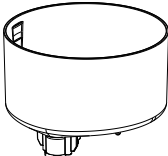
Turn the lid to the left slightly in order to reach the centrifuge and inner container	
Centrifuge (consisting of centrifuge strainer and shredder disc)	
Shredder disc	
Spout unit	
Inner container	
The packaging material (cardboard, PE plastic film and EPS expanded polystyrene) is labelled and should be recycled if possible and disposed of with due regard for the environment.	

Before start of operation

Place the Novis VitaJuicer on a dry and even surface so that the spout is at the front and the switch is on the right.

Before using the Novis VitaJuicer for the first time, wash all the removable parts and wipe the housing with a damp cloth (see section on product care and cleaning).



Fully assemble the Novis Vita Juicer before plugging it in at the mains
(220-240 volt alternating current; frequency: 50/60 Hz).

Shortening the cable

If you place the Novis VitaJuicer near a plug socket, you can shorten the cable by winding it up in the base of the appliance.

Follow the steps below:

1. Remove the lid, inner container, juicer attachment, reamer and centrifuge, etc.
2. Place the Novis VitaJuicer upside down on a soft cloth.
3. Unclip the cable from the holder.
4. Wind the cable round in the base once or twice, leaving the correct amount of cable for the distance from the socket.
5. Clip the cable back into the holder.

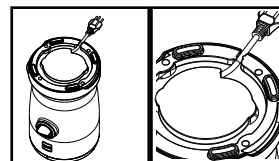

Operation

// Juicing without smoothie/puree unit

Ideal for hard fruits and vegetables: apples, carrots, cucumbers, etc.

Result: A natural juice without pulp.

Preparation

Wash hard fruits and vegetables and cut into pieces

1. Insert spout unit
2. Insert inner container
3. Assemble centrifuge (centrifuge strainer, shredder disc)
4. Insert centrifuge
5. Fit lid and turn to the right to lock in place
6. Place a glass or a different container underneath the spout
7. Start the machine (move switch to position I)
8. Put the prepared pieces of fruit or vegetable into the feed chute and press them down slowly with the pusher. Continue until you have juiced the required quantity.
9. When you want to change the glass, push the spout up. The DropHold fitting will prevent any dripping. When you have changed the glass, push the spout down. The juicing process can now be resumed.
10. Switch off the Novis VitaJuicer when the juice has virtually stopped flowing (move switch to position 0).

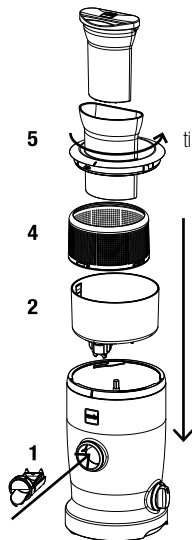
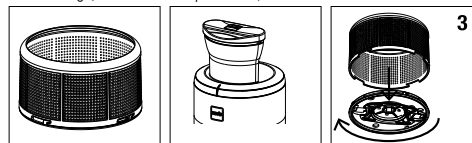

Never reach into the feed chute with any utensils or with your fingers. Only use the pusher provided. Do not open the appliance until the centrifuge has come to a complete standstill. Never use the centrifuge without the centrifuge strainer. Make sure that the centrifuge strainer is correctly fitted and locked in position (red indicators on the outside in line with strainer).

// Juicing with smoothie/puree unit

Ideal for soft or stewed fruits and vegetables: raspberries, currants, tomatoes, etc.

Result: A smooth and thick juice (purée)



Never put hard fruits or vegetables in the Novis VitaJuicer when you are using the smoothie unit as this could damage the Novis VitaJuicer.

Preparation

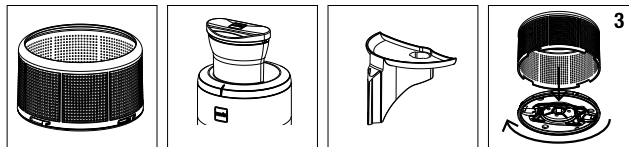

Hard fruits or vegetables

- Wash
- Cut into chunks
- Stew

Soft fruits or vegetables

- Wash
- Cut into chunks

1. Insert spout unit
2. Insert inner container
3. Assemble centrifuge (centrifuge strainer, shredder disc)
4. Insert centrifuge
5. Fit smoothie/puree unit on spindle on lid, turn to the left and lock in position.
6. Fit lid and turn to the right to lock in place
7. Place a glass or a different container underneath the spout

8. Start the machine (move switch to position I)
9. Put the prepared pieces of fruit or vegetable into the feed chute press them down slowly with the pusher. Continue until you have juiced required quantity.
10. When you want to change the glass, push the spout up. The Dropfold fitting will prevent any dripping. When you have changed the glass, push spout down. The juicing process can now be resumed.
11. Switch off the Novis VitaJuicer when the juice has virtually stopped flowing (move switch to position

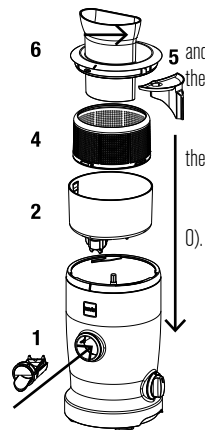
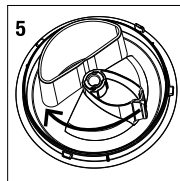

Never reach into the feed chute with any utensils or with your fingers. Only use the pusher provided. Do not open the appliance until the centrifuge has come to a complete standstill. Never use the centrifuge without the centrifuge strainer. Make sure that the centrifuge strainer is correctly fitted and locked in position (red indicators on the outside in line with strainer).

// Citrus press without centrifuge (CitroMax)

Ideal for citrus fruits: oranges, lemons, grapefruit, etc.

Result: A speedily prepared juice with some pulp and without any pips

Preparation

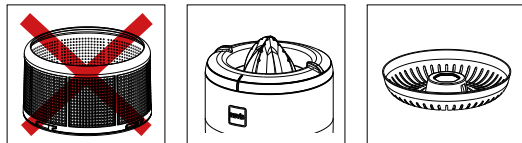

- Wash citrus fruits
- Cut each fruit in half

1. Insert spout unit
2. Insert inner container
3. Insert citrus cover (turn to the left to click in place)
4. Insert citrus sieve
5. Place citrus reamer/CitroMax on top
6. Place a glass or a different container underneath the spout
7. Start the machine (move switch to position I)
8. Press the fruit down onto the reamer by hand and the juice will be extracted. Continue until you have juiced the required quantity of fruit. When you want to change the glass, push the spout up. The DropHold fitting will prevent any dripping. When you have changed the glass, push the spout down. The juicing process can now be resumed.
9. Switch off the Novis VitaJuicer when the juice has virtually stopped flowing (move switch to position 0)

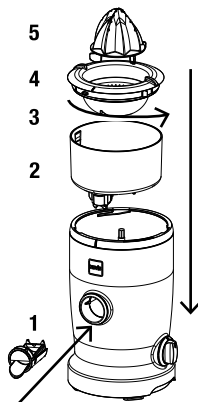

// Citrus press with centrifuge (VitaTec)

Ideal for citrus fruits: oranges, lemons, grapefruit, etc.

Result: Freshly squeezed juice with maximum juice extraction without any pips and without any pulp.

Preparation

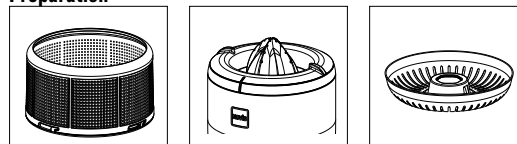

- Wash citrus fruits
- Cut each fruit in half

1. Insert spout unit
2. Insert inner container
3. Assemble centrifuge, centrifuge strainer and shredder disc
4. Insert centrifuge
5. Insert citrus cover (turn to the left to click in place)
6. Do not fit citrus sieve
7. Place citrus reamer/CitroMax on top
8. Place a glass or a different container underneath the spout
9. Start the machine (move switch to position I)
10. Press the fruit down onto the reamer by hand and the juice will be extracted. Continue until you have juiced the required quantity of fruit.
11. When you want to change the glass, push the spout up. The DropHold fitting will prevent any dripping. When you have changed the glass, push the spout down. The juicing process can now be resumed.
12. Switch off the Novis VitaJuicer when the juice has virtually stopped flowing (move switch to position 0).

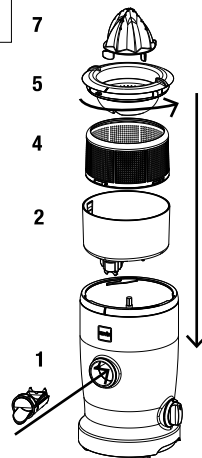

Tips

DropHold

The flow of juice can be interrupted briefly to change the glass. Push the spout up to interrupt the flow. The DropHold fitting will halt the flow and prevent any dripping. When you have changed the glass, push the spout down again. The juicing process can now be resumed.



Emptying the centrifuge

The centrifuge should be emptied regularly when juicing relatively large quantities. If the Novis VitaJuicer starts to vibrate, the centrifuge should also be emptied.

1. Stop the Novis VitaJuicer (move switch to vertical position 0)
2. Remove lid or juicer attachment
3. Take out centrifuge
4. Take centrifuge strainer and shredder disc apart
5. Empty centrifuge strainer, tapping it lightly to release the contents

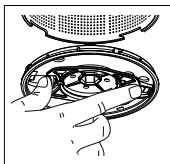
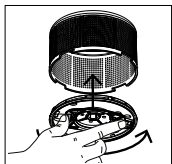

Maximising juice extraction

In order to maximise the juice yield, do not press down too hard on the pusher so as to allow the fruit or vegetable to be completely shredded on the grater. Leave the Novis VitaJuicer running for a few more seconds at the end until all the juice has run out.

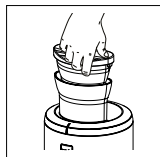

Dual protection



The appliance will only work if the juice container is inserted and the lid or pulp collector is correctly fitted.

Product care and cleaning

- Set the switch in vertical position (at 0).
- Unplug the Novis VitaJuicer from the mains before cleaning it.
- Remove all the detachable parts:

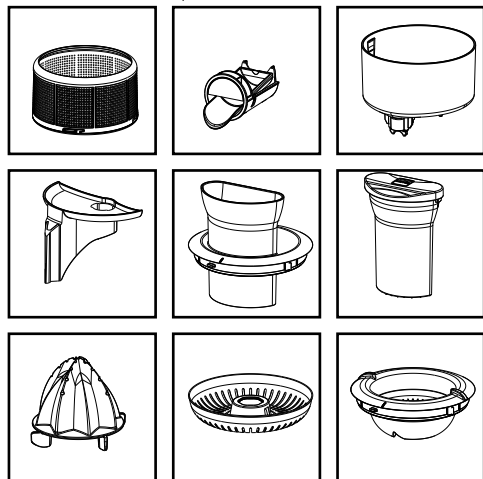

- Turn the lid to the left slightly to remove it.

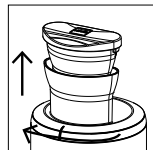

- Remove the centrifuge and inner container before taking out the spout unit.
- Wipe the housing with a damp, warm cloth and a little washing-up liquid.
- Wipe the housing dry with a soft cloth. Do not use abrasive agents or scouring pads.
- All the removable parts can be washed in the dishwasher as long as they are put in the top section of the machine. Do not wash on high-temperature cycles (avoid temperatures over 60°C).
- Take the centrifuge apart and remove the crushed residues before placing it in the dishwasher.

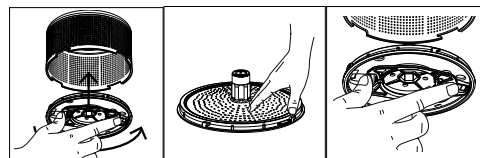

The shredder disc is sharp. Handle it with care.



Remove the lid of the pusher to clean it in the dishwasher.



Do not use abrasive agents or scouring pads when washing and rinsing the parts. They can scratch the parts or remove the coating. Dry all the parts after washing.

Troubleshooting



In the event of a fault, the appliance must be unplugged from the mains and the switch set to position 0.

Novis VitaJuicer not running

- Make sure that the inner container is fitted properly and that the lid or pulp collector is lined up correctly and locked in position.
- Is the Novis VitaJuicer plugged in at the mains?
- Is there a fault with the fuse in the Novis VitaJuicer?
If you are using a circuit-breaker, make sure that the circuit is closed.
- Unplug the Novis VitaJuicer from the mains and plug the plug back in the socket.

Juice not flowing out

- Make sure that the spout unit is fitted correctly and that the spout is pressed down.
- Is the centrifuge correctly assembled and locked in position?

Novis VitaJuicer vibrating

- Empty the centrifuge (see section on product care and cleaning)
- Is the centrifuge correctly assembled and locked in position?

Centrifuge blocked

- Empty the centrifuge (see section on product care and cleaning)

If the fault cannot be remedied, contact your stockist or the relevant address in the section on after-sales service.

Repairs to the Novis VitaJuicer may only be carried out by the official service points. Unprofessional repairs can put the user at risk. No liability can be accepted for any damage if repairs are not carried out in the proper way. Claims on the warranty will not be honoured in such cases.

Disposal

This appliance is marked in compliance with the requirements set out in European Directive 2002/96/EC on waste electrical and electronic equipment (WEEE).

Please dispose of the Novis VitaJuicer in the proper way in the interests of environmental protection and public health. Take the Novis VitaJuicer out of use immediately at the end of its service life. Unplug from the mains and disconnect the mains lead.



This symbol indicates that this appliance must not be thrown away with the household rubbish. It must be taken to a collection point for waste electrical and electronic equipment. Please contact your local council or stockist for information regarding the appropriate collection points.

Technical data

Rated voltage	220-240 volts
Rated wattage	240 watts
Frequency	50/60 hertz
Maximum dimensions (width x depth x height)	22x23x43 cm / 8.7x9x17 inch
Height of spout	15,2 cm/6 inch
Weight	6,8 kg/15 lb
Cable length	1m/3,28 ft
Housing material	Die-cast housing
Spout material	Stainless steel
Conformity tests	EN / IEC 60335 (IEC60335-2-14 and IEC60335-1)

Warranty

Warranty period:	Costs covered by the Novis warranty:	Costs not covered by the Novis warranty:
2 (two) years from date of purchase for Novis VitaJuicer used in the household	Spare parts and labour for rectification of material damage and manufacturing defects. The repairs must be carried out by an approved Novis after-sales service centre.	Repairs to Novis VitaJuicer which are used for purposes other than normal household juice preparation. Repairs to damage caused by accidents, modifications, misuse, improper installation or incorrect operation in breach of the applicable electrical regulations.
Novis shall not accept liability for incidental costs and damages.		

After-sales service

All repairs and servicing work should be carried out locally by an approved Novis VitaJuicer after-sales service centre. Please contact your stockist or look on the website for the relevant information:

novissa.com

The operating instructions can be downloaded from **novissa.com**.

Producer and Importer

Novissa Switzerland AG
Schulstrasse 1a
2572 Sutz
T: +41 32 475 1015
E-Mail: info@novissa.com



READ MANUAL ONLINE

NOVISSA.COM/MANUAL